

SPARE PARTS SECTION



Always quote lathe Serial
Number in all parts orders or
technical enquiries.

This number is stamped into
lathe bed at tailstock end.

CLAUSING SERVICE CENTER

811 EISENHOWER DR., SO.

P.O. BOX 877

GOSHEN, IN 46526

CLAUSING MACHINE TOOLS : ELGIN : ILL : U.S.A.

Manufactured by

THE COLCHESTER LATHE COMPANY LTD : COLCHESTER : ENGLAND

SPARE PARTS SECTION



Always quote the Serial
Number in all parts orders or
technical enquiries.
This number is stamped into
the head of rollers and

CLAUSING SERVICE CENTER
211 BROADWAY, 2ND FL.
NEW YORK, N.Y. 10038

CLAUSING MACHINE TOOLS : ELGIN : ILL : U.S.A.
Manufactured by
THE CHESTER LATHE COMPANY LTD - COLCHESTER : ENGLAND

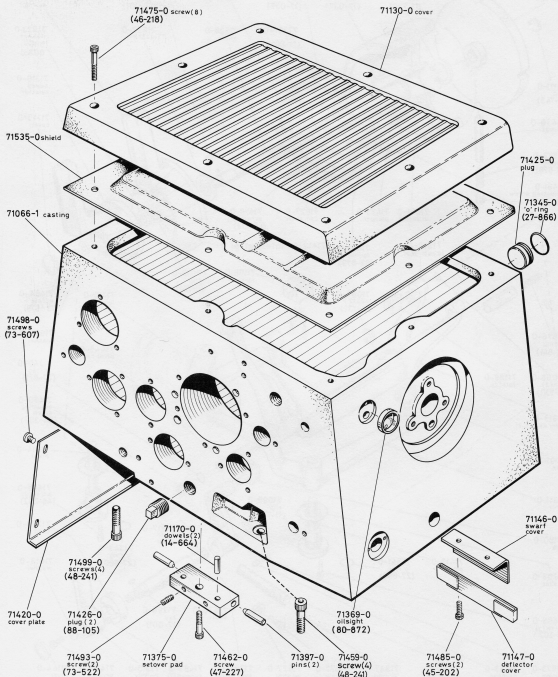

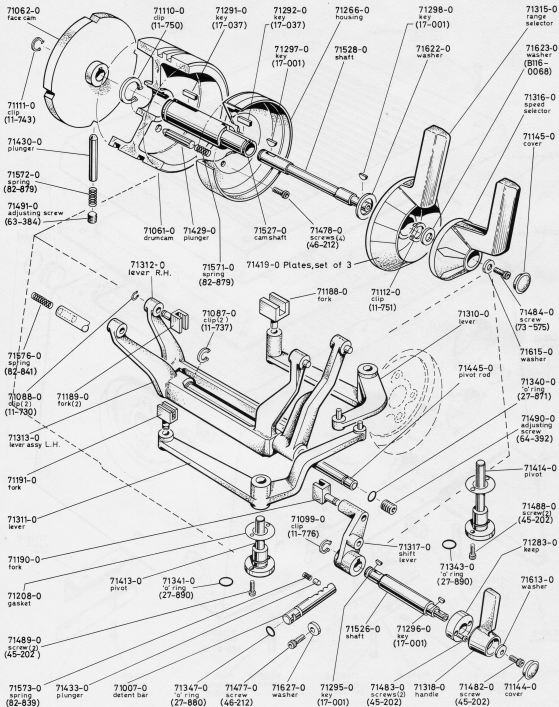

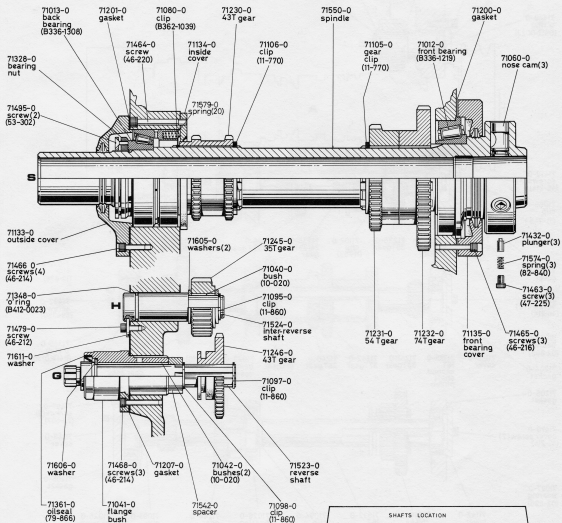

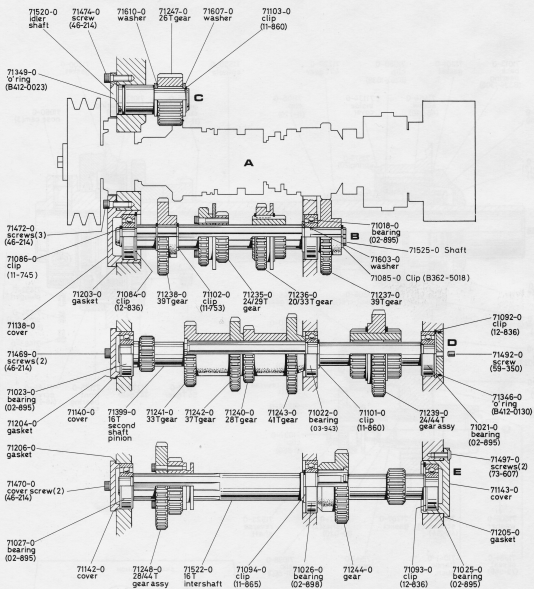

HEADSTOCK ; CLUTCH SHAFT

MATRIX CLUTCHES

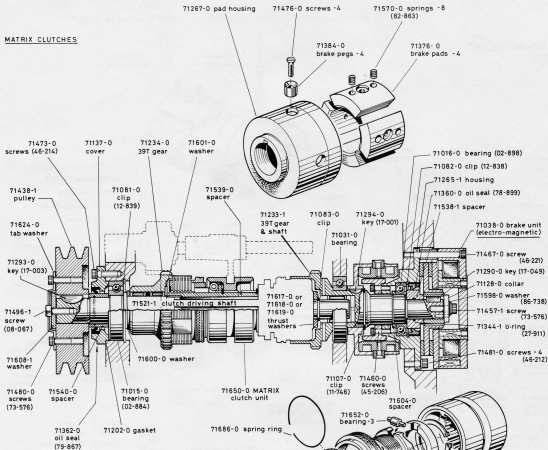

MATRIX clutch assembly - 71650-0

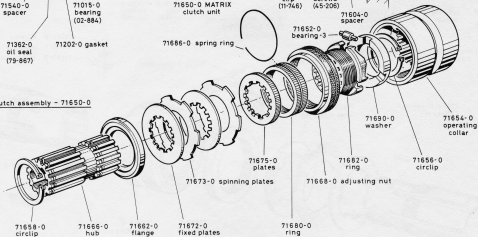

HEADSTOCK; CLUTCH SHAFT

ORTLINGHAUS UNITS

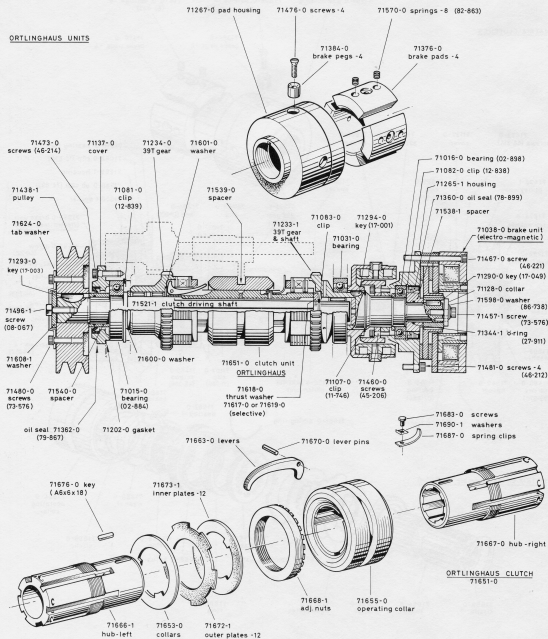

CLAUSING ONLY

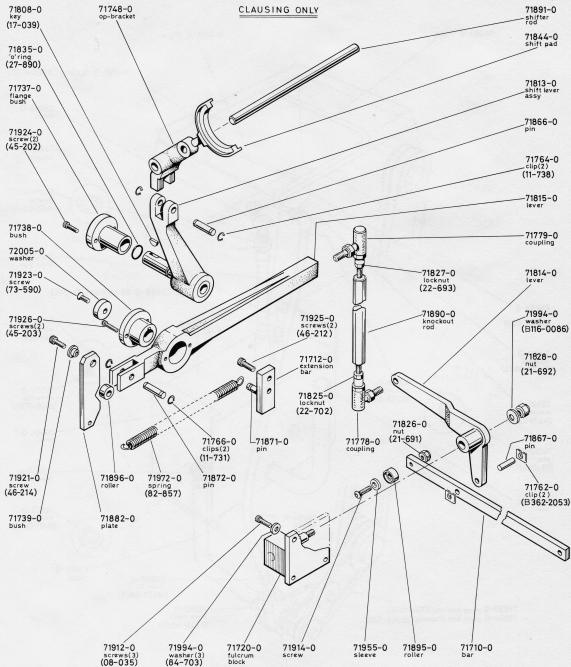

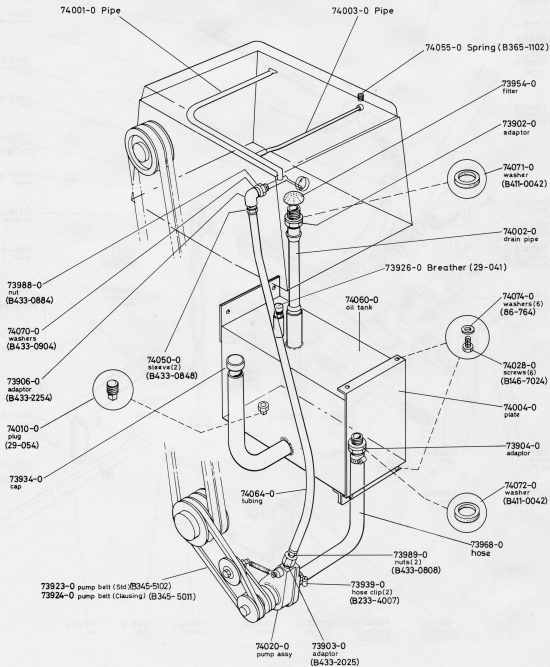

HEADSTOCK; LUBRICATION PUMP

FROM SER.No.08745
TO SER.No.

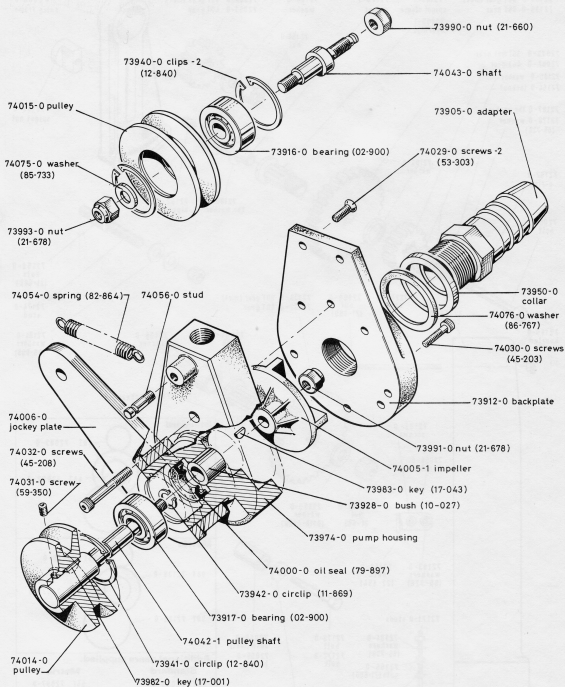

5-09-7905

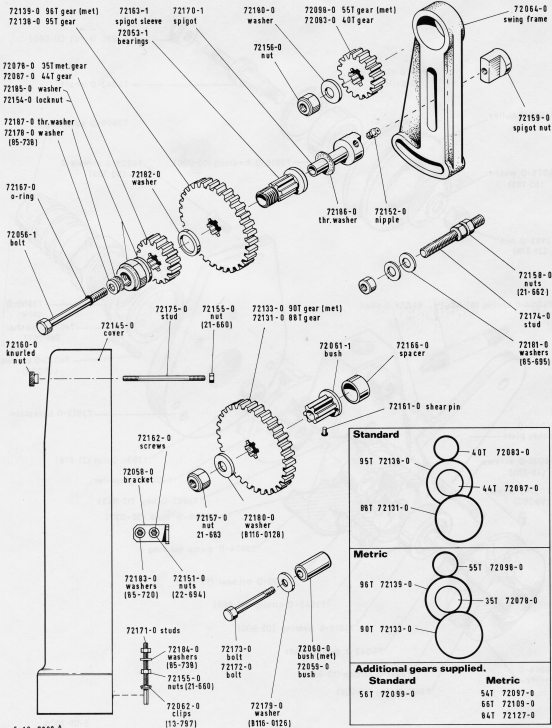

Standard	
95T 72138-0	40T 72093-0
96T 72139-0	44T 72067-0
98T 72131-0	
Metric	
96T 72139-0	55T 72096-0
98T 72133-0	35T 72078-0
Additional gears supplied.	
Standard	Metric
56T 72099-0	54T 72097-0
	66T 72109-0
	84T 72127-0

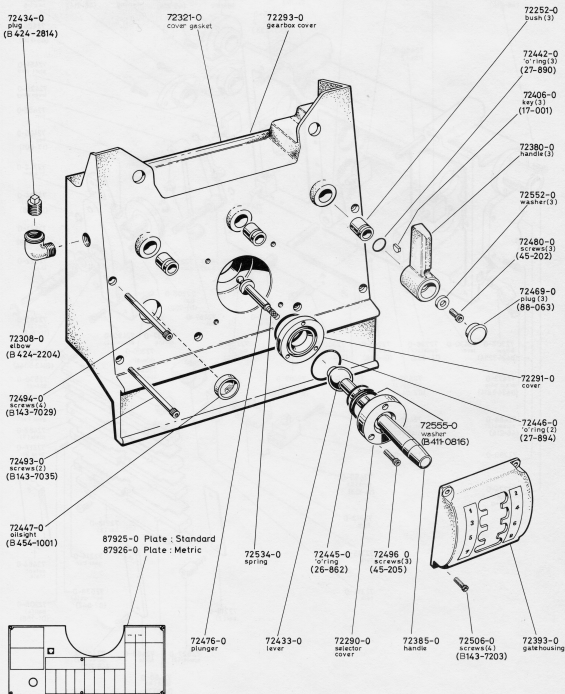

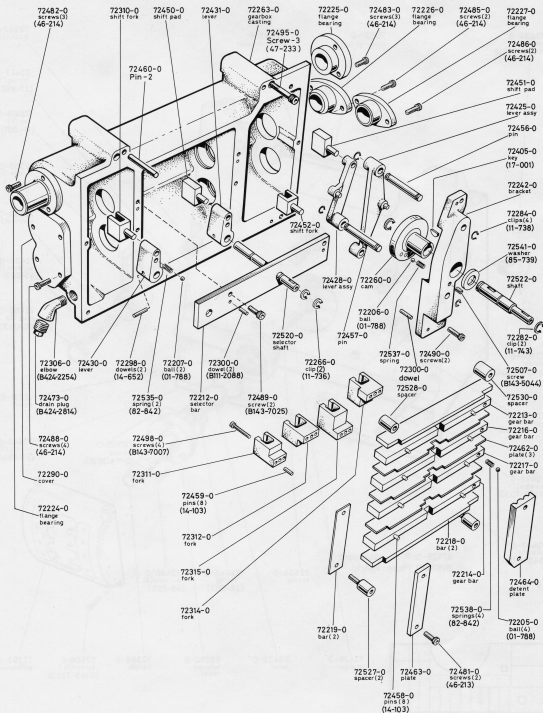

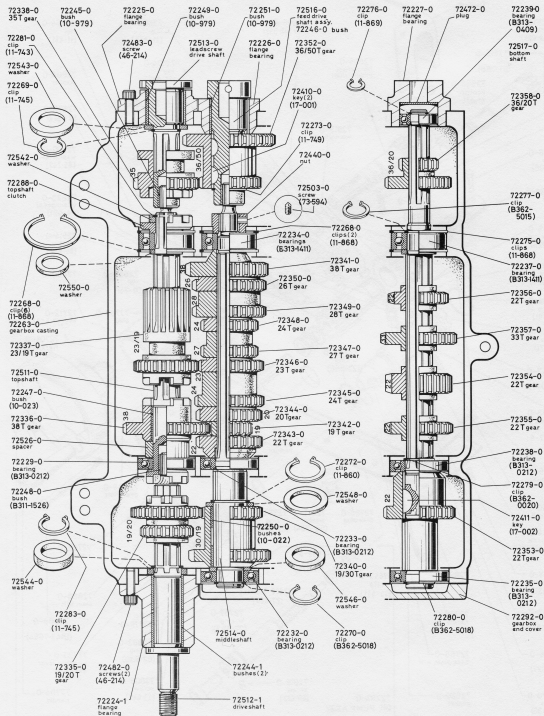

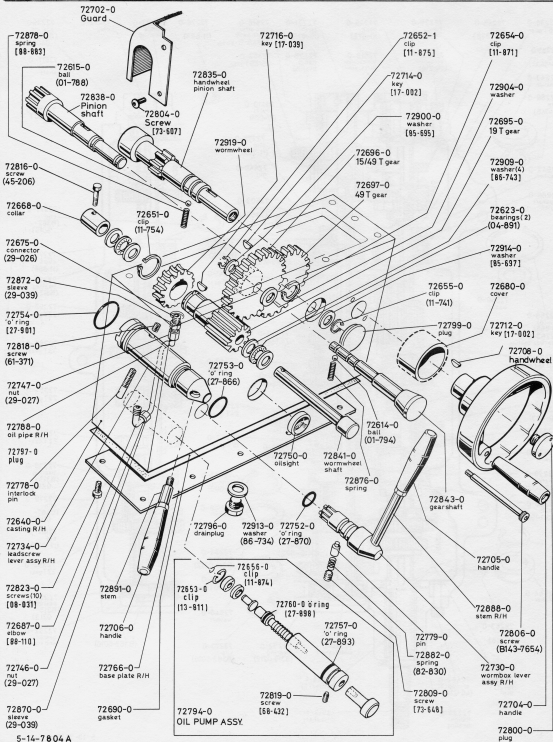

5-14-7804 A

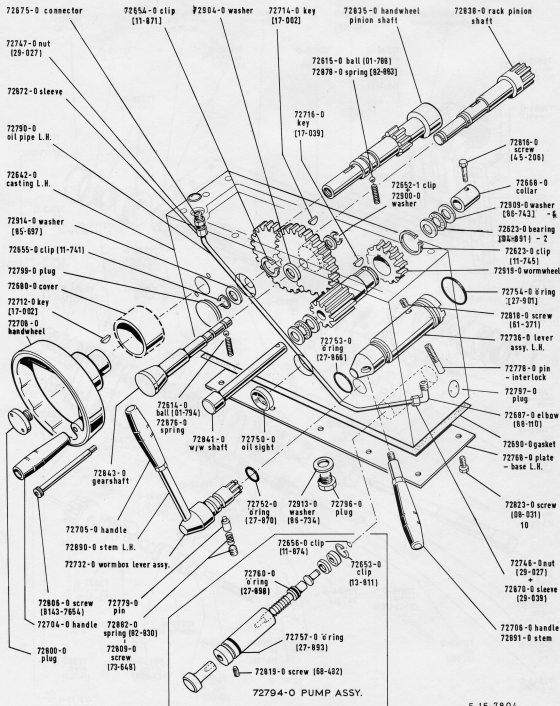

5-15-7804

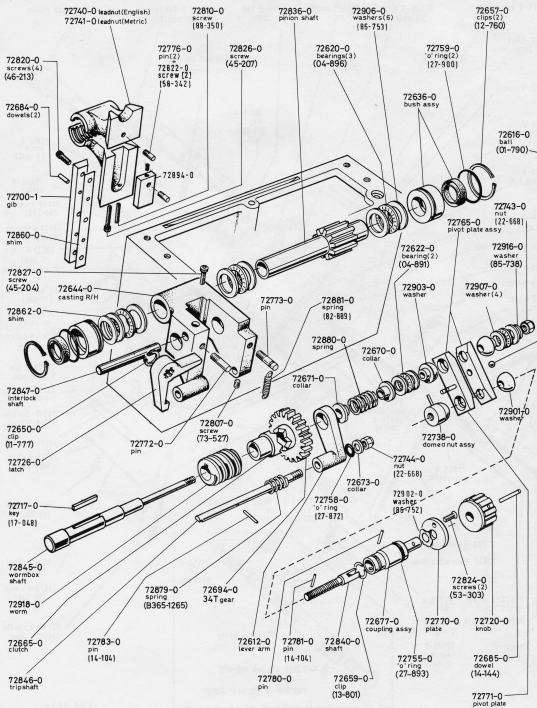

5-16-7804 A

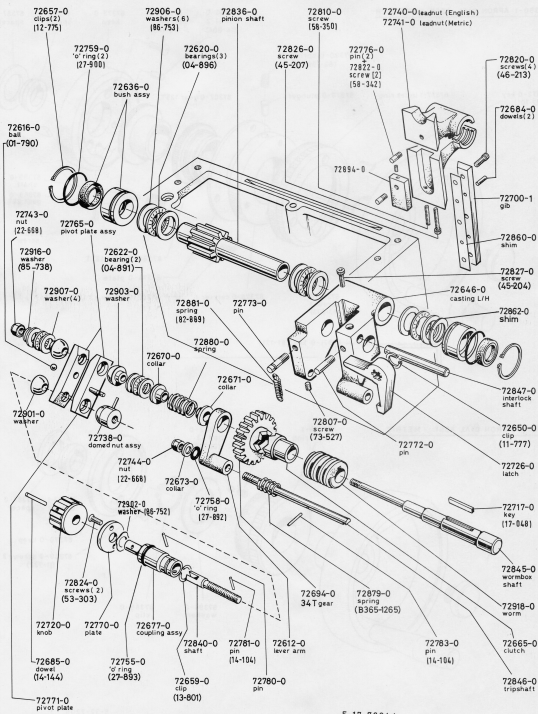

87350-1 APRON DIAL ASSY. - STD. INCH

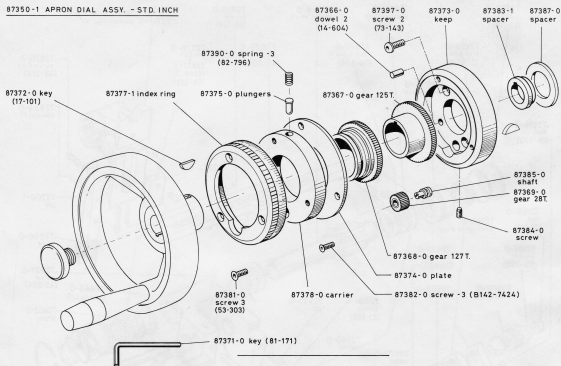

87355-1 APRON DIAL ASSY. - METRIC

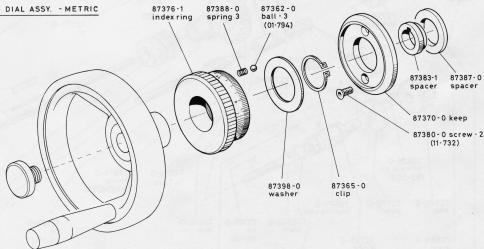

72925-0 DIAL INDICATOR ASSEMBLY (English)

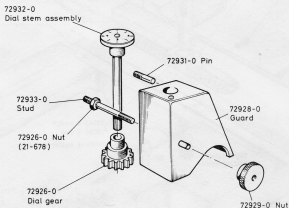

ENGLISH

72935-0 DIAL INDICATOR ASSEMBLY (Metric)

METRIC

For setting
instructions
read the plate
on front of the
guard, and on
top surface.

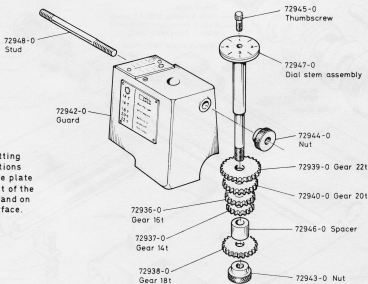

**SADDLES ASSEMBLIES
WITH DUAL DIALS**

FROM SERIAL NUMBER 0 8818
TO SER. NO.

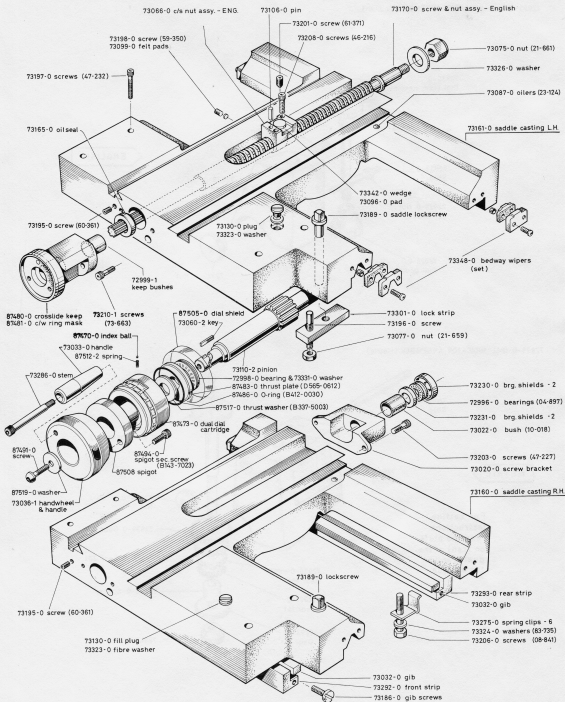

5-19-8205-C1

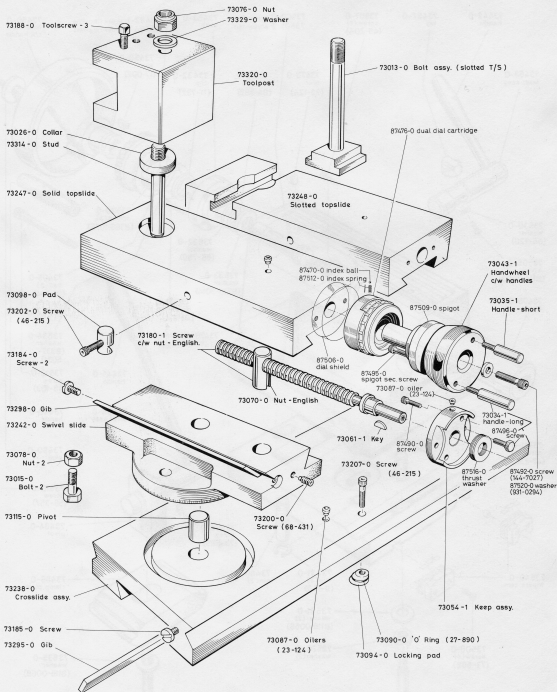

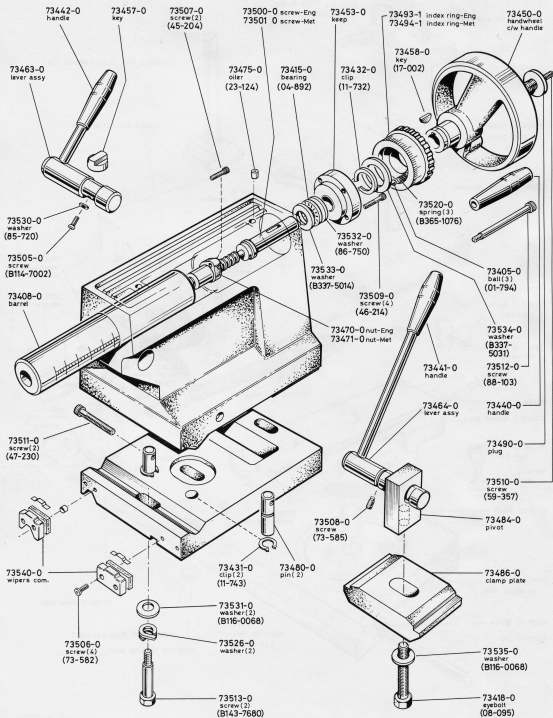

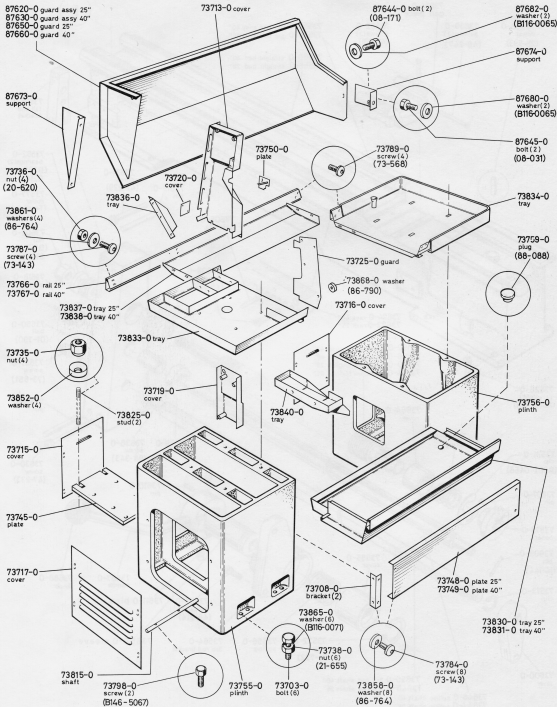

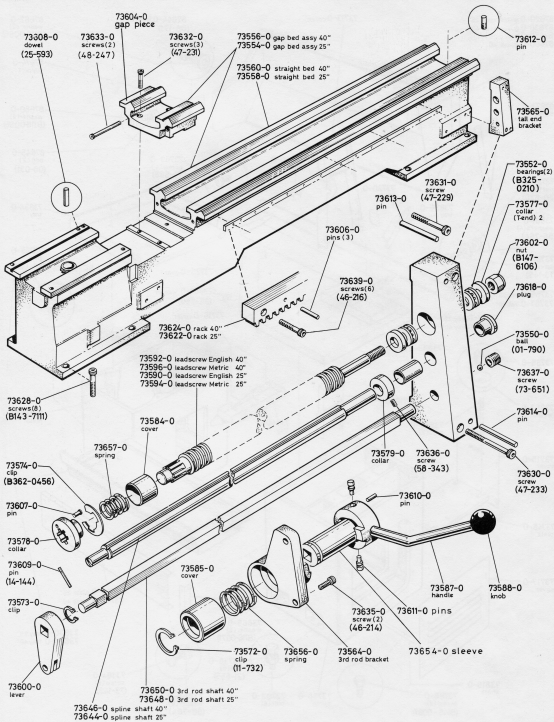

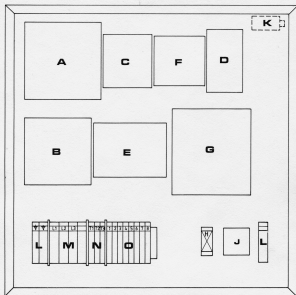

NOTE: Typical layout of main electrical units. Check layout plan in panel of lathe as variations may occur.

1. CONTROL PANEL 115V control voltage.

	208 / 230V	440V	575V
1. Control Panel, complete	74402-2	74404-2	74405-2
A Disconnect switch (DISC)	74568-1 (B762-5067)		
B Main motor contactor (C1)	74448-3 (B763-1144)		
C Coolant motor contactor (C2)	74453-3 (B763-1139)		
D Brake contactor-manual (C3)	74455-0 (B763-1142)		
E Main motor overload (OL1)	74505-2 (B763-8157)	74507-1 (B763-8164)	74508-1 (B763-8158)
F Coolant motor overload (OL2)	74515-2 (B763-8161)	74517-2 (B763-8153)	
G Transformer (T 1)	74582-1 (B772-3016)		
H Control Fuse	74470-0		
J Brake rectifier (N1)	74535-0 (B708-0036)		
K Limit switch (3B1)	74565-0 (B755-2116)		
L Earth terminals (Z1)	74574-0 74575-0	(B718-2090)-2 (B718-2091)-1	
M Mains terminals	74576-0 (B718-2099)		
N Profiler terminals	74577-0 (B718-2007)		
O Control terminals	74577-0 (B718-2007)		

2. PUSH BUTTON STATION

1 Push Button Station	74436-1	B767-0631
2 Stop push button	74438-2	B762-5421
3 Stop button contact block	74417-0	B762-5437
4 Start button	74428-0	B762-5422
5 Start button contact block	74418-0	B762-5436
6 ILL. Brake release button	74429-0	B762-5425
7 Release button contact block	74418-0	B762-5436
8 Coolant selector switch	74569-1	B762-5432
9 Coolant selector contact block	74417-0	B762-5437
10 Filament bulb	74480-1	B781-3916

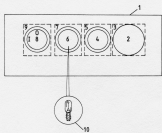

MAIN MOTOR	5 HP/3ph/60 Hz
208V	74487-0
230/440V	74488-0
575V	74489-0

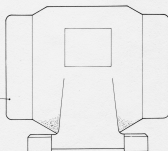

Year	Month	Day	Time	Location	Activity
1998	12	15	10:00
1998	12	16	11:00
1998	12	17	12:00
1998	12	18	13:00
1998	12	19	14:00
1998	12	20	15:00
1998	12	21	16:00
1998	12	22	17:00
1998	12	23	18:00
1998	12	24	19:00
1998	12	25	20:00
1998	12	26	21:00
1998	12	27	22:00
1998	12	28	23:00
1998	12	29	24:00
1998	12	30	25:00
1998	12	31	26:00

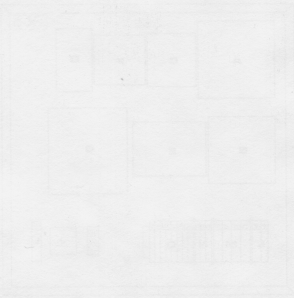

Year	Month	Day	Time	Location	Activity
1999	1	1	10:00
1999	1	2	11:00
1999	1	3	12:00
1999	1	4	13:00
1999	1	5	14:00
1999	1	6	15:00
1999	1	7	16:00
1999	1	8	17:00
1999	1	9	18:00
1999	1	10	19:00
1999	1	11	20:00
1999	1	12	21:00
1999	1	13	22:00
1999	1	14	23:00
1999	1	15	24:00
1999	1	16	25:00
1999	1	17	26:00
1999	1	18	27:00
1999	1	19	28:00
1999	1	20	29:00
1999	1	21	30:00
1999	1	22	31:00

