

BED STOP; 6 POSITION LONGITUDINAL

FROM SER. No.00001
TO SER.No.

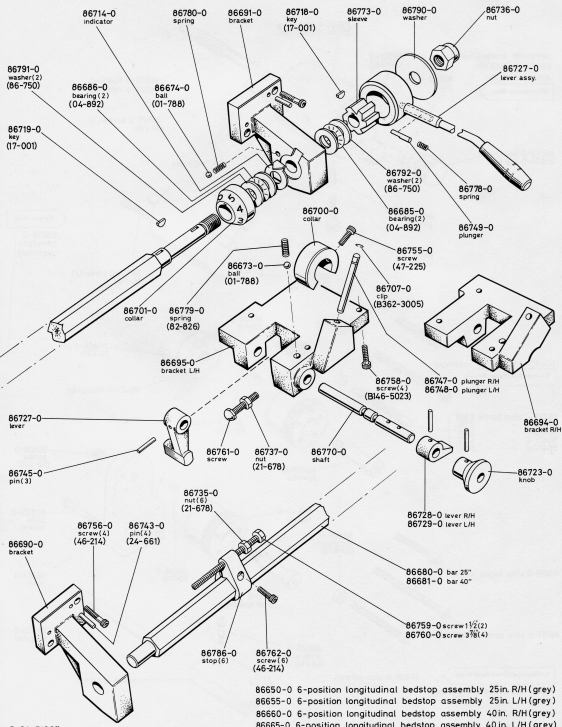

- 86650-0 6-position longitudinal bedstop assembly 25in. R/H(grey)
- 86655-0 6-position longitudinal bedstop assembly 25in. L/H(grey)
- 86660-0 6-position longitudinal bedstop assembly 40in. R/H(grey)
- 86665-0 6-position longitudinal bedstop assembly 40in. L/H(grey)

CAPSTAN UNIT

FROM October 1975

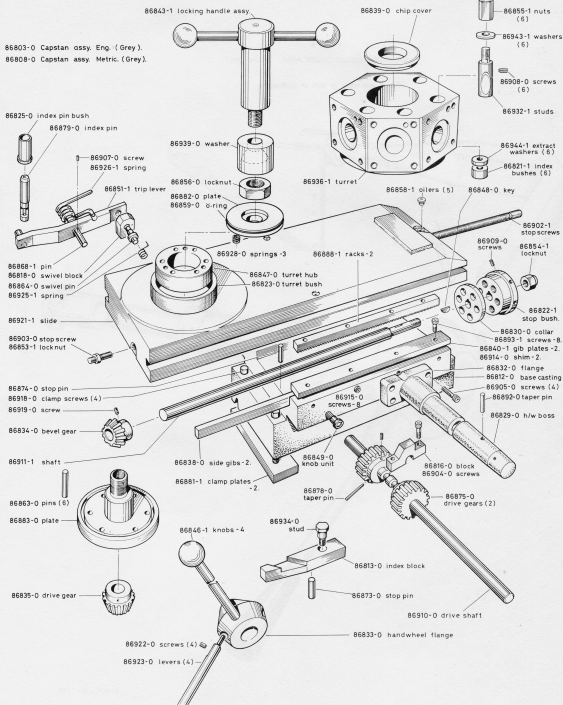

5-42-7911

87120-0

DRAW-BAR COLLET CHUCK ASSY. (Accro type)

collets available in mm. or inch sizes

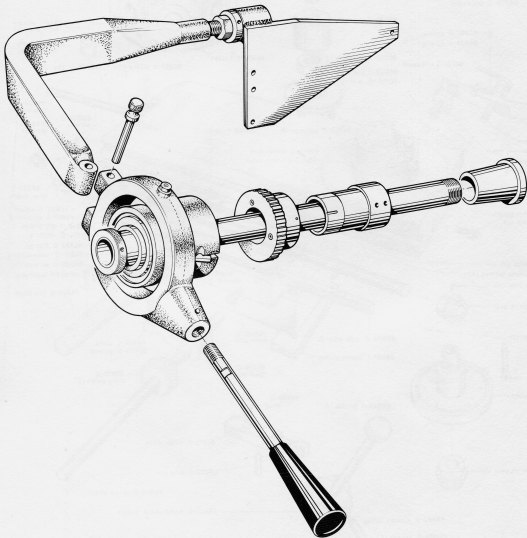

5-ACC 490-7910

COOLANT UNIT

FROM SER. No. 00420
TO SER. No.

87210-1	Pump, tank & fittings assy	208-3-60
87211-1	" " " "	230/460-3-60
87212-1	" " " "	575-3-60

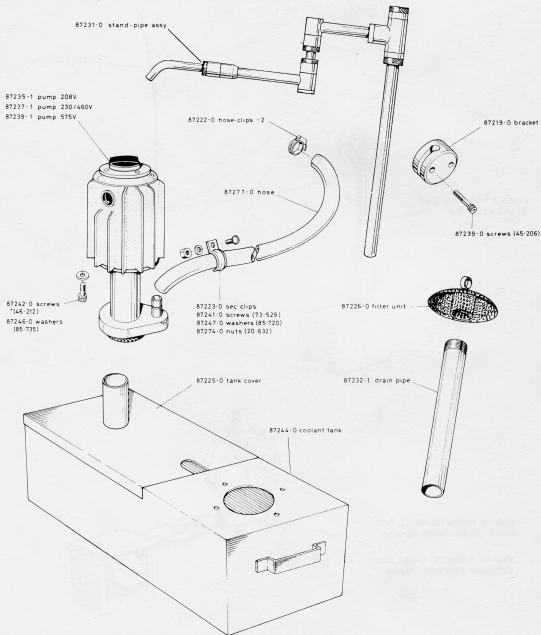

A 26-7305

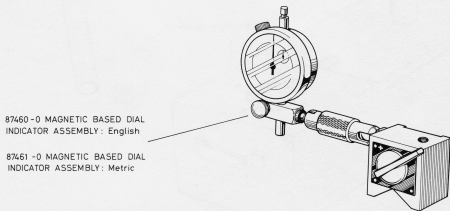
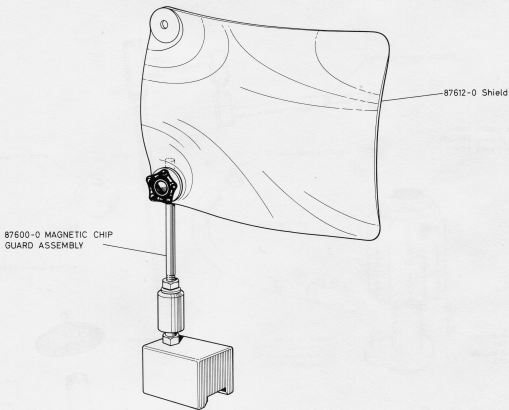

CHIP GUARD

FROM SER.No. 00550
TO SER.No.

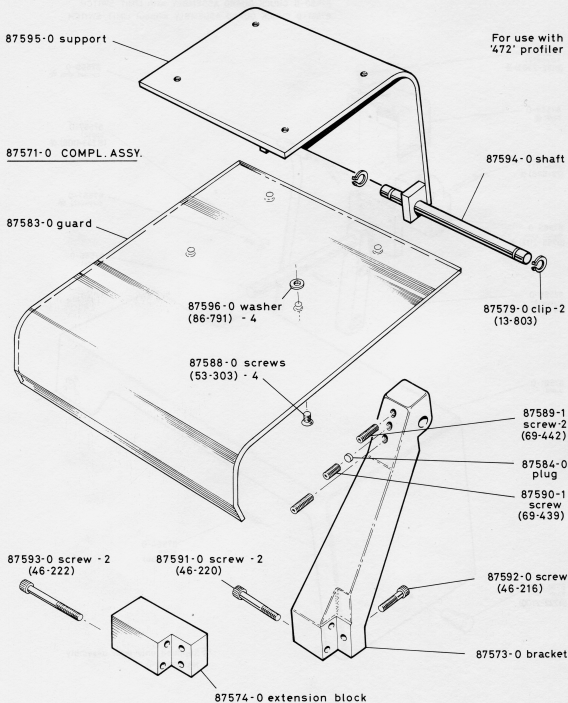

5-37-7207

87550-0 CHUCK GUARD ASSEMBLY with LIMIT SWITCH
87551-0 CHUCK GUARD ASSEMBLY without LIMIT SWITCH

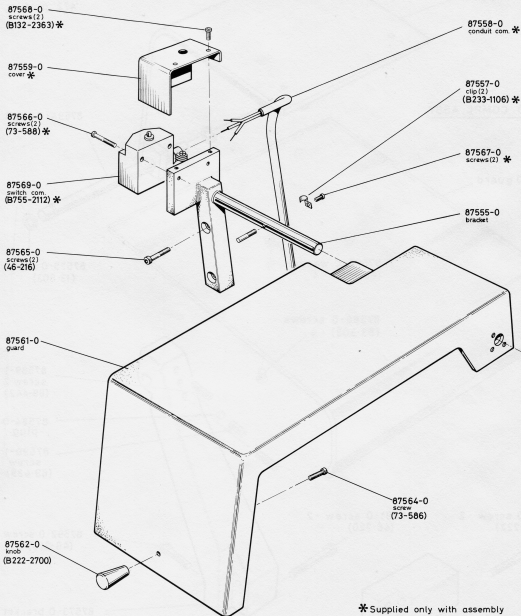

- 87850-1 Light unit complete (bayonet)
- 87857-0 Light unit complete (screw in)

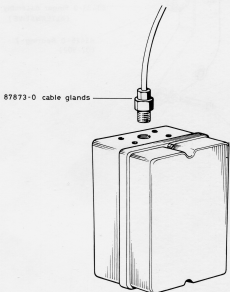
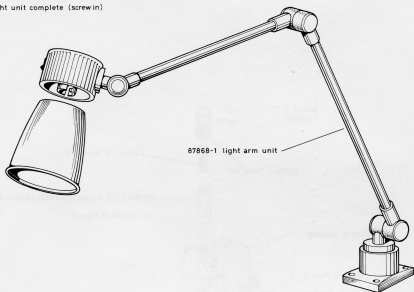

TRANSFORMERS

T 256 - 210/230/250V.25V	87888-1
T 255 - 210/230/250V.50V	87882-1
T 254 - 365/380/415/440V.25V	87890-1
T 253 - 365/380/415/440V.50V	87884-1
T 257 - 500/550V.50V	87886-1

88368-0 TRAVELLING STEADY ASSEMBLY

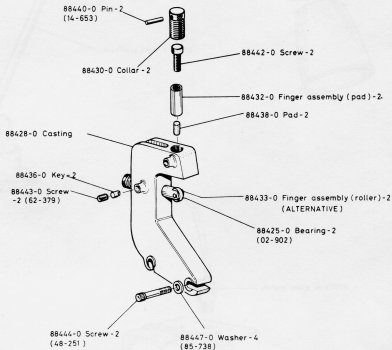

88368-0 STATIONARY STEADY

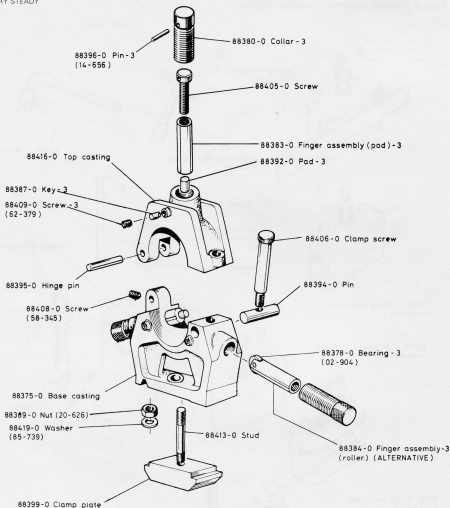

FRONT TOOLPOST ; QUICK-CHANGE

FROM SER No. 00001
TO SER No.

88650-0 TOOLPOST ASSEMBLY (for solid top slide)
88652-0 TOOLPOST ASSEMBLY (for slotted top slide)

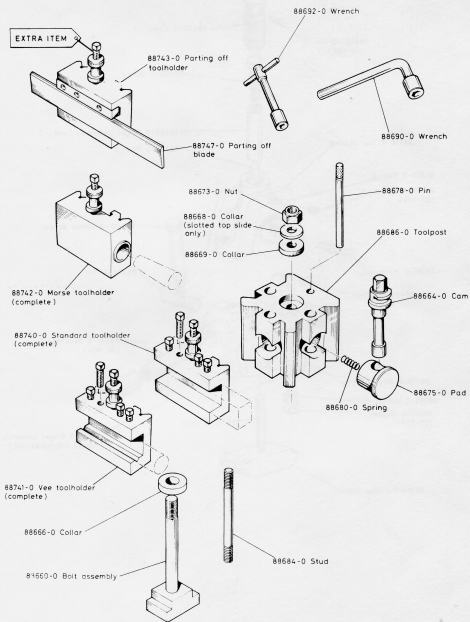

5-27-7106

88840-0 TOOLPOST COMPLETE ASSY.

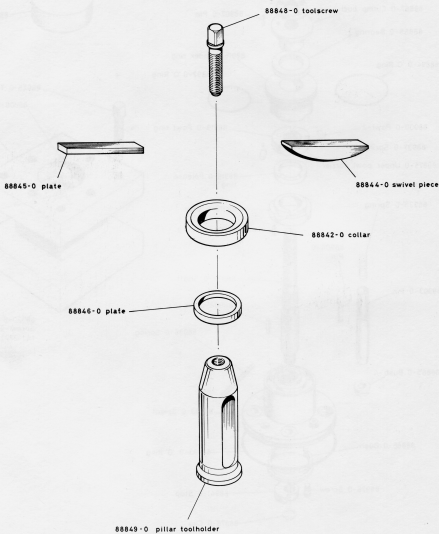

(for Armstrong T-1-S & FT-1-S and 1-S & 1-L toolholders)

TOOLPOST ; 4 WAY TURRET

FROM SER No. 00001
TO SER No.

88850-0 TOOLPOST ASSEMBLY (solid topslide)

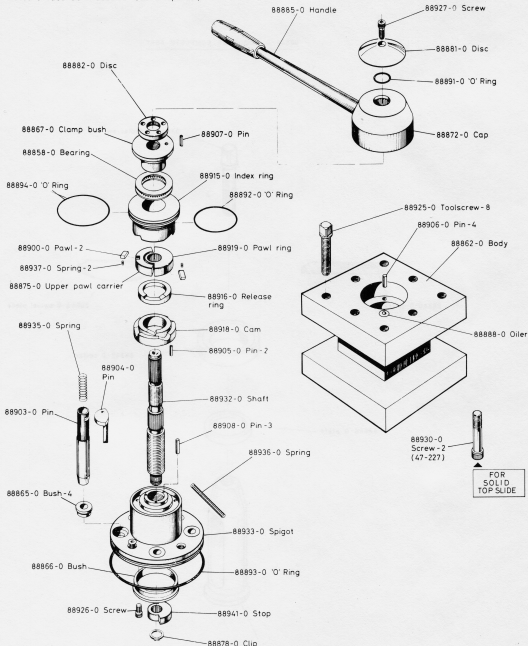

5-28-7105

REAR TOOLPOST; STANDARD

FROM SER No 00001
TO SER No

88800-0 REAR TOOLPOST : STANDARD COMPLETE

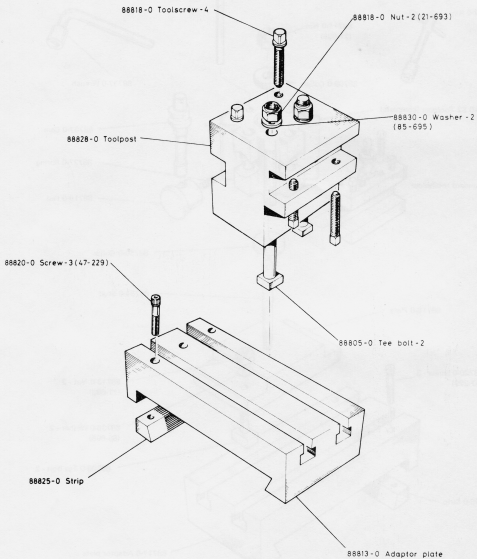

5-29-7106

88700-0 REAR TOOLPOST QUICK CHANGE COMPLETE

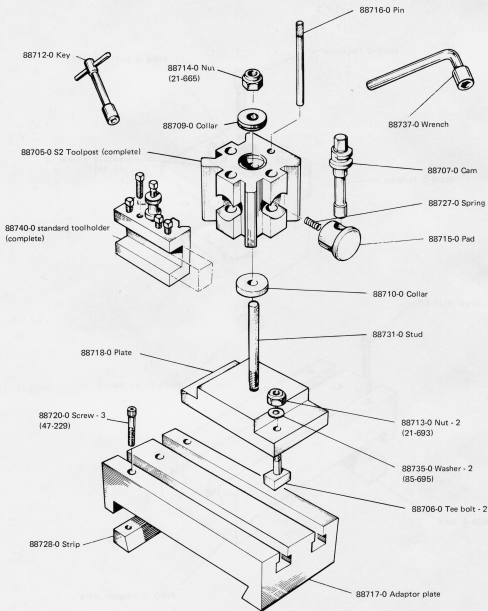

RAPID THREADER UNIT; ENGLISH

FROM 5ER, No. 00001
TO 5ER, No.

Type 0433 or 5000

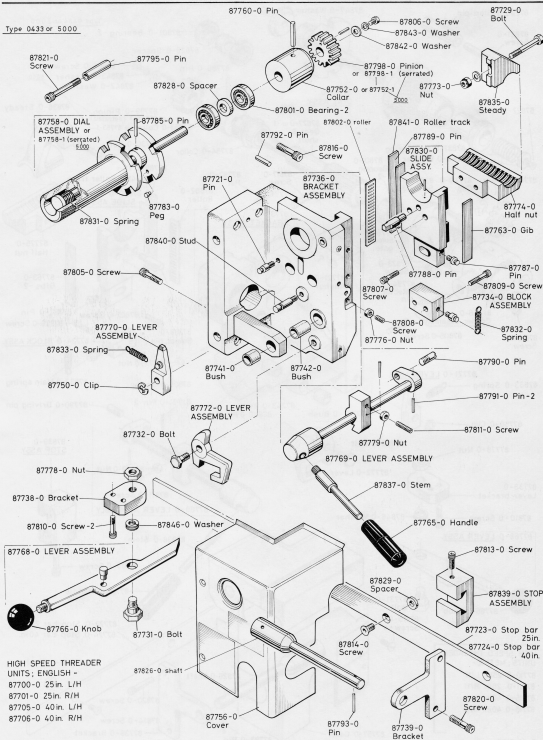

HIGH SPEED THREADER UNITS; ENGLISH -
87700-0 25in. L/H
87701-0 25in. R/H
87705-0 40in. L/H
87706-0 40in. R/H

5-44-7106A

TAPER TURNER

FROM SER No. 1980
TO SER. No.

88550-2 TAPER TURNER ASSY. (grey)

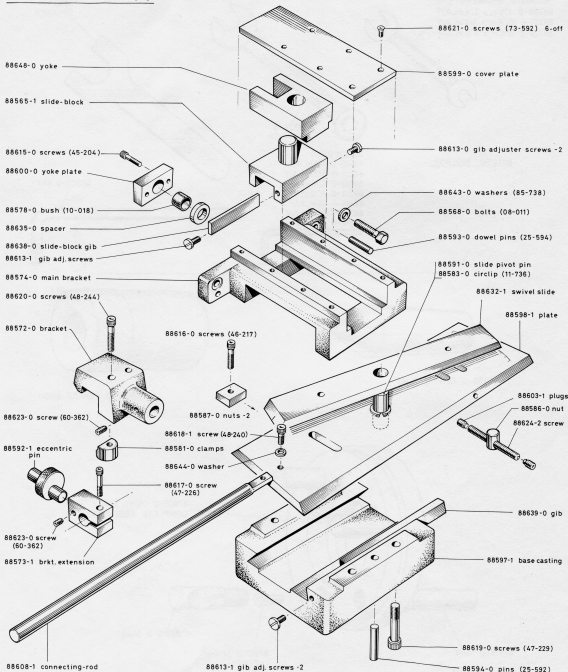

5-39-7912

88300-0 TOOL KIT COMPLETE

Standard SPANNERS :

88320-0 1 1/4 in. x 3/4 in. A/F

88321-0 15/16 in. x 3/4 in. A/F

88322-0 9/16 in. x 7/16 in. A/F

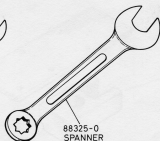
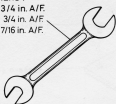
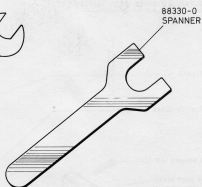
88325-0
SPANNER88330-0
SPANNER

88301-0 TOOLBOX

ALLEN KEYS :

88310-0 1/8 in. A/F

88311-0 5/32 in. A/F

88312-0 3/16 in. A/F

88313-0 7/32 in. A/F

88314-0 1/4 in. A/F

88315-0 5/16 in. A/F

88316-0 3/8 in. A/F

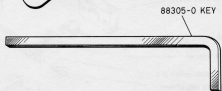
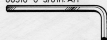

88305-0 KEY



86950-0 CENTRE 3 MT.

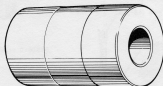

86967-0 CENTRE BUSH

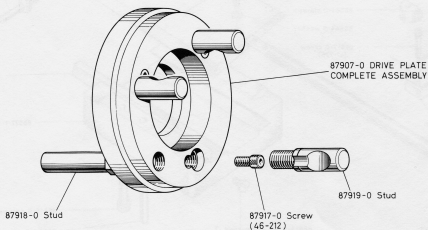
87907-0 DRIVE PLATE
COMPLETE ASSEMBLY

87918-0 Stud

87917-0 Screw
(46-212)

87919-0 Stud

LONGITUDINAL POSITIONING DIALS

87450-1 'Trav-a-dial' assy. English - Grey.
87455-1 'Trav-a-dial' assy. Metric - Grey.

